

NEW



## VIKING WINDOW TILT & SLIDE DOOR

Estonian bespoke manufacturer Viking Window AS offers different types high quality wood and wood-aluminium clad windows and doors. Established in 1996 our main markets are Norway, Sweden, Denmark, Ireland, Japan, France and UK.



General frameworks that are applied in Viking Window: ISO 9001 and ISO 14001, British standard BS 644 and FSC Chain of Custody.

Addition to this our high priorities are outstanding quality and durability, client friendly service, fast delivery and environmentally friendly materials.



**Tilt & slide door offered by Viking Window** is an inward-opening exterior door with **additional tilt function door** with a single casement. It is based on same profile system as Viking inward opening wooden window. In addition to traditional sideways slide opening it tilts at the top for ventilation.

### Advantages of the Viking tilt & slide door:

- Practical tilt and and slide functions combined in a single casement
- Excellen thermal performance U-value of 0.95 W/m<sup>2</sup>K
- FSC-certified timber
- Easy cleaning
- Durability and ease of use
- Made to measure every time

The sliding doors by Viking Window are made using high-quality solid wood. We use premium Nordic laminated pinewood and vacuum impregnation to guarantee the long service life of the wooden parts.

The doors have double-glazed units or triple-glazed units for greater energy efficiency. The insulating glass units can consist of various types of panes, depending on the user's requirements - reinforced/safety glass, energy-saving or acoustic glass, glass with sun protection properties.

**Tilt & slide door:** is a sliding patio door with **additional tilt function**. It is based on same profile system as Viking inward opening wooden window. In addition to traditional sideways slide opening it tilts at the top for ventilation.



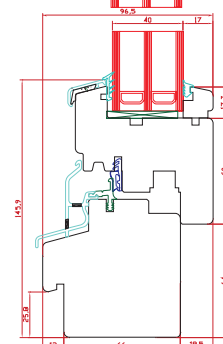
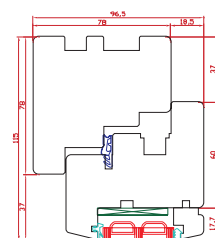
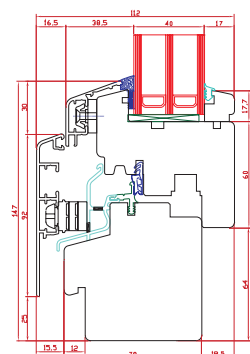
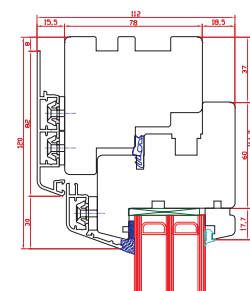

## Technical specification:

- Cross sections: jamb 78x78mm; frame 78x78mm; post between panels, vertical 105x78mm, horizontal 78x78mm; tenon-jointed window bar 54x78mm and 83x78mm.
- Laminated pinewood A1 to A3.
- The wooden parts have been vacuum-impregnated with GORI impregnation liquid.
- Closures: GU hinge system, Hoppe handles.
- Glass and cores: double-glazed (26 mm) or triple-glazed (40mm) glass unit; veneer or MDF core panel with expanded foam layer (26mm or 40mm).

## Warranty

All products come with a five year warranty.

[www.vikingwindow.eu](http://www.vikingwindow.eu)

HEAD OFFICE AND PRODUCTION  
Mäo 72751 Järva County Estonia  
Phone +372 384 8900  
Fax +372 385 3027  
e-mail: [info@viking.ee](mailto:info@viking.ee)  
[www.vikingwindow.eu](http://www.vikingwindow.eu)