



## VIKING INWARD-OPENING ALUMINIUM-CLAD WOODEN WINDOW

Viking Window AS is an Estonian company which started the production of wood windows and exterior doors in 1997. Today the company has become one of the leading manufacturers of wood and aluminum clad windows and doors. Its products are highly valued on the international market. In addition to the United Kingdom and Ireland, Viking Window products are sold to Sweden, Norway, Denmark, Iceland, France and Japan. Viking Window is renowned for the high quality of the products, customer service and short lead times. All products are made to measure from environmentally friendly materials sourced sustainably.



Since 2000 Viking Window AS quality management system complies with the ISO 9001 standard. Since 2005 company's environmental management system complies with the ISO 14001 standard.



The mark of responsible forestry

Since 2007, we have the FSC® Chain of Custody certificate which proves that we use timber from responsibly managed forests.



In 2009 compliance to Norwegian Door and Window standards was certified.

**Viking Window's inward-opening aluminium-clad wood window** is an inward-opening, tilt and/or turn type window with a single frame. It is a window with a practical design, as the window can be opened in two different ways - it opens traditionally to the side and tilts at the top for ventilation.

### Advantages of the inward-opening aluminium-clad wood window:

- Practical tilt and/or turn functions combined in a single window
- Very good weather resistance
- Long service life
- Contemporary design
- Easy cleaning and maintenance
- Energy efficient windows - double glazed  $U_w = 1,29 \text{ W/m}^2\text{K}$ ; triple glazed  $U_w = 0,94 \text{ W/m}^2\text{K}$

The aluminium-clad wood windows are made of high-quality solid wood. On the outside, the windows feature powder-coated aluminium cladding. We use premium Nordic laminated pinewood to guarantee the long service life of the wooden parts.

The windows can be fitted with double-glazed or triple-glazed units (for greater energy efficiency). We use premium quality Nordic laminated pinewood to guarantee longevity of wooden parts. Depending on customer's requirements, the insulated glazing units can consist of various types of panes - reinforced/safety glass, energy efficient or acoustic glass, glass with sun protection properties etc. Besides rectangular windows, we also offer solution for angular and rounded openings.

For window bars, customers can choose between bars glued on the glass unit, tenon-jointed bars, bars glued on the glass unit with a decorative grille of simulated bars installed within the glazing unit, or removable bars.

If multiple frames are combined into the same jamb, it is possible to have a window without a mullion between the panels/frames. In that case, the passive frame will only open to the side and the active frame will open to the side as well as tilt from the top.

All windows which can be opened have a handle in the middle of the jamb, relative to the height of the jamb. Tilt-and-turn windows have a handle on the vertical frame, and tilt windows have a handle on the top horizontal frame.



# VIKING WINDOW AS

## Tilt-and-turn window

The window opens inwards, in two different ways – it opens fully inwards, hinged at the side (like the turn window), or tilts a little inwards from the top, into a ventilation position.

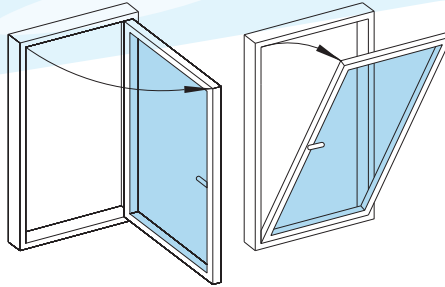

## Turn window

This is a traditional inward-opening side-hung window, which doubles as an fire escape, if necessary.

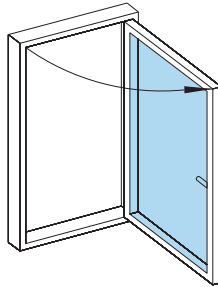

## Tilt window

The window tilts inwards from the top, but only a little, to allow ventilation.

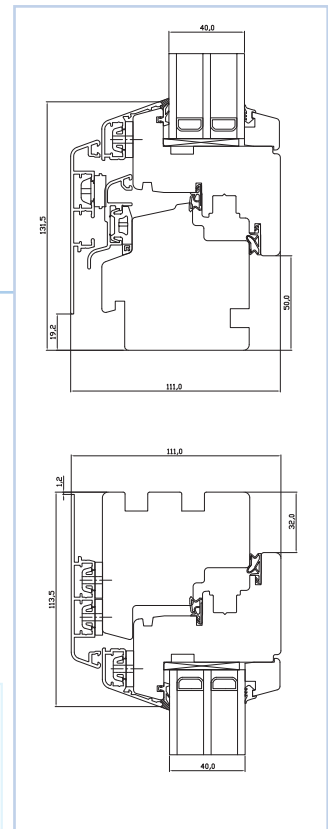
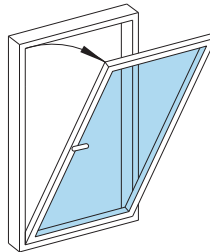

## Technical specifications of the window

- Cross sections: frame 78 x 78 mm; structural glazing bar 70 x 78 mm; 26 mm glued bar.
- Engineered timber A1-A3.
- All wooden parts have been factory painted. Paint manufacture Teknos OY has more than 30 years of experience with wooden windows.
- Glazing: double-glazed units (thickness 26 mm)  $U_w = 1,29 \text{ W/m}^2\text{K}$  or triple glazed energy efficient units (thickness 40 mm)  $U_w = 0,94 \text{ W/m}^2\text{K}$ . For warm edge solution SGG Swisspacer bar is recommended.
- Window fittings: Roto hardware, Hoppe Tokyo handles.



EN 14351-1:2006 + A1:2010

## Warranty

All products come with a five year warranty.

[www.vikingwindow.eu](http://www.vikingwindow.eu)

HEAD OFFICE AND PRODUCTION  
Mäo 72751 Järva County Estonia  
Phone +372 384 8900  
Fax +372 385 3027  
e-mail: [viking@viking.ee](mailto:viking@viking.ee)  
[www.vikingwindow.eu](http://www.vikingwindow.eu)